

Door-tray  
2 drawers

AUFS—16" wide x 85" high  
AUQS—16" wide x 90" high  
APUF—24" wide x 85" high  
APUQ—24" wide x 90" high

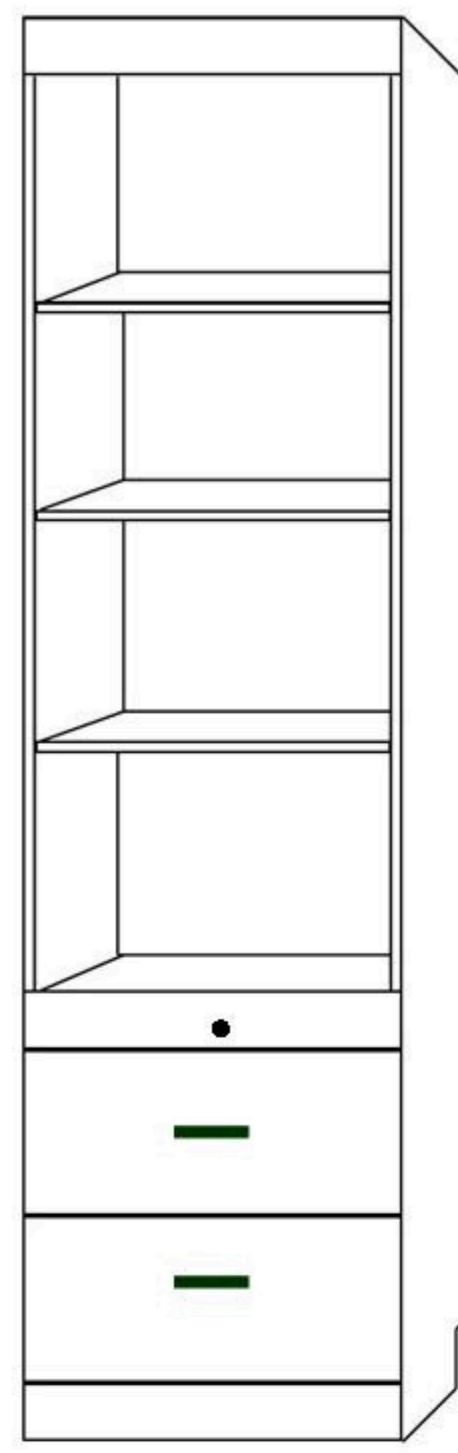

pull out tray  
2 drawers

ANFS—16" wide x 85" high  
ANQS—16" wide x 90" high  
APNF—24" wide x 85" high

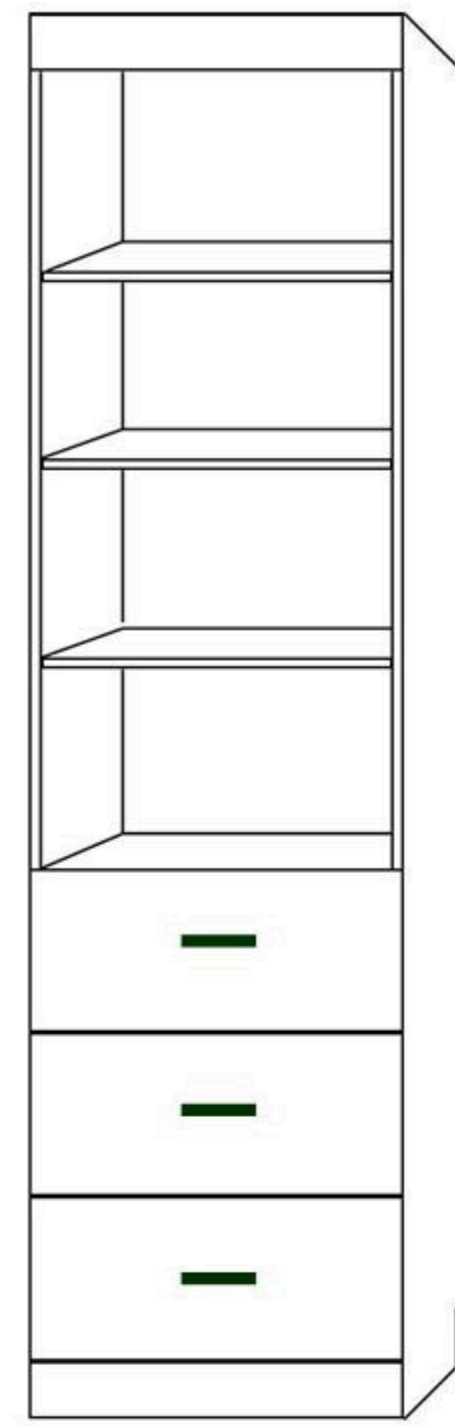

3 drawers

ATFS—16" wide x 85" high  
ATQS—16" wide x 90" high  
APTF—24" wide x 85" high  
APTQ—24" wide x 90" high  
APGF—32" wide x 85" high

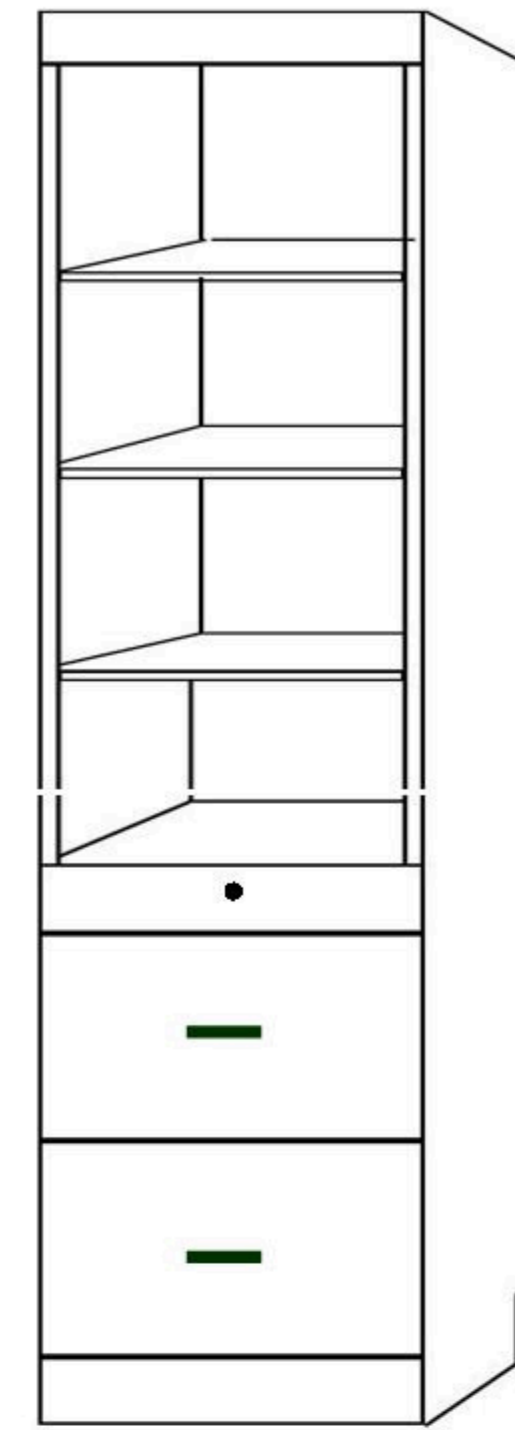

Pull out tray  
2 file drawers

ALFS—16" wide x 85" high  
ALQS—16" wide x 90" high  
APLF—24" wide x 85" high  
APLQ—24" wide x 90" high

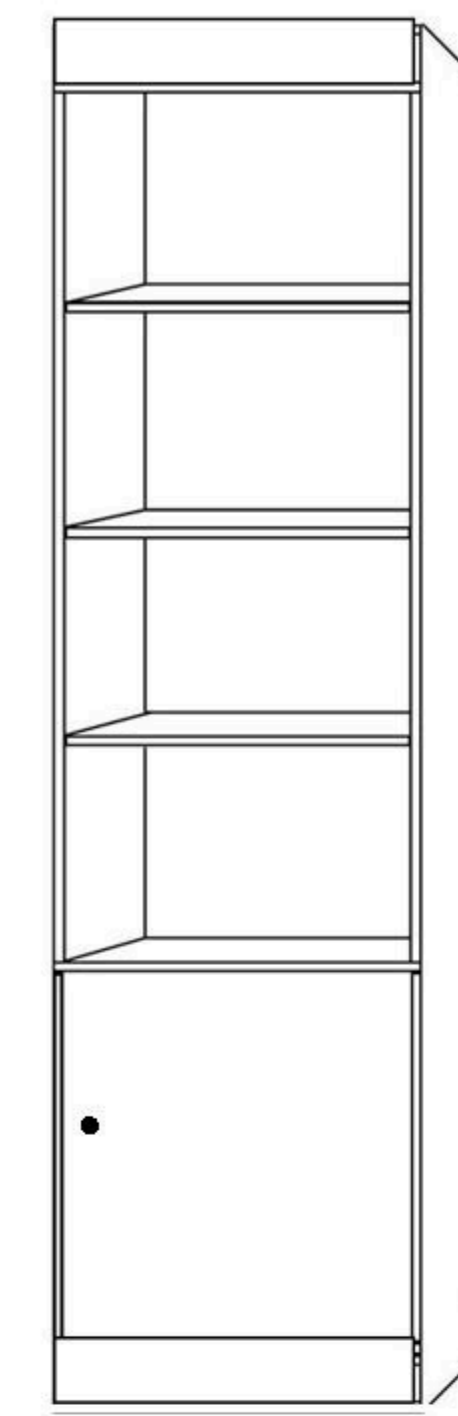

door

ADFS—16" wide x 85" high  
ADQS—16" wide x 90" high  
APCF—24" wide x 85" high  
APCQ—24" wide x 90" high  
two doors  
ADFL—32" wide x 85" high  
ADQL—32" wide x 90" high

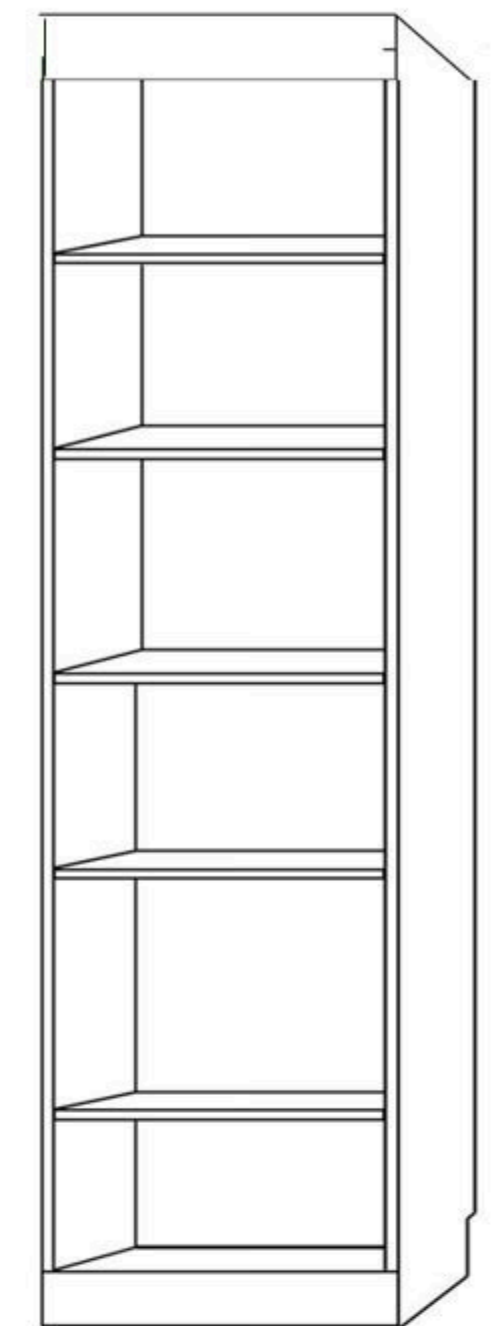

bookcase

ABFS—16" wide x 85" high  
ABQS—16" wide x 90" high  
APBF—24" wide x 85" high  
APBQ—24" wide x 90" high  
ABFL—32" wide x 85" high  
ABQL—32" wide x 90" high

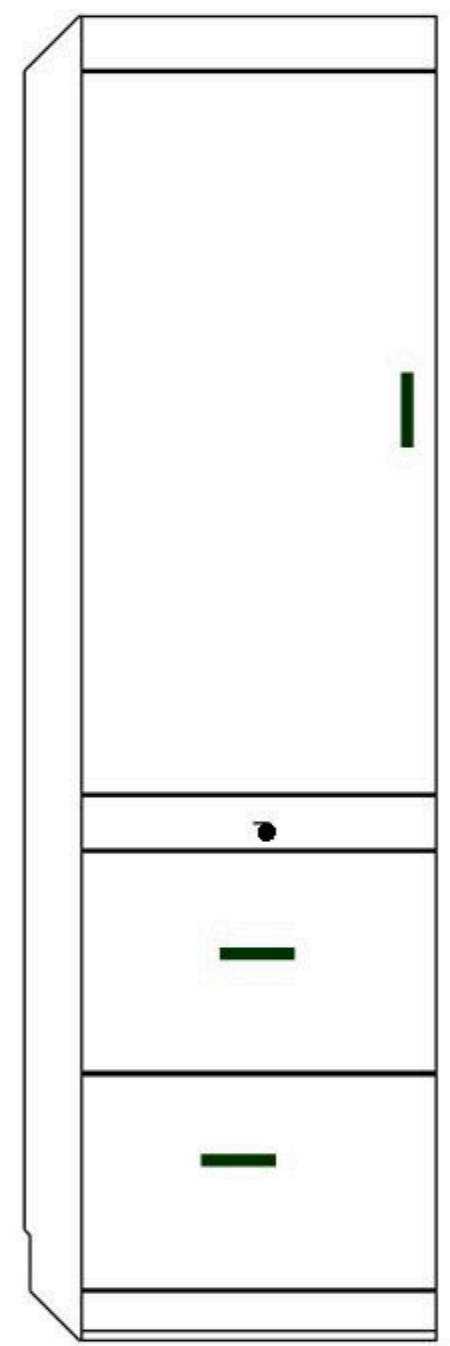

wardrobe door  
pull out tray  
2 file drawers

AXFS—16" wide x 85" high  
AXQS—16" wide x 90" high  
APXF—24" wide x 85" high  
APXQ—24" wide x 90" high

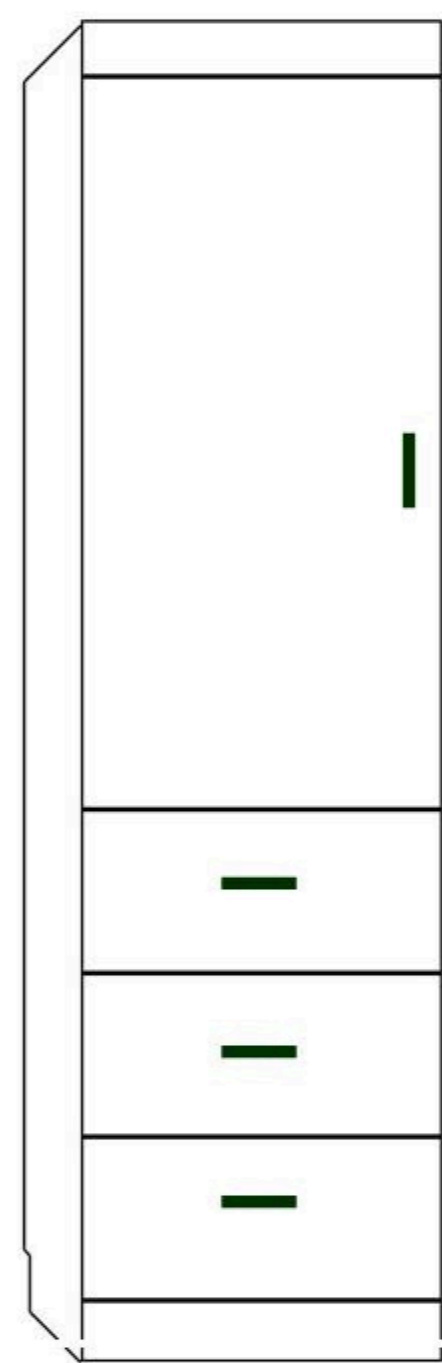

wardrobe door  
3 drawers

AWFS—16" wide x 85" high  
AWQS—16" wide x 90" high  
APWF—24" wide x 85" high  
APWQ—24" wide x 90" high

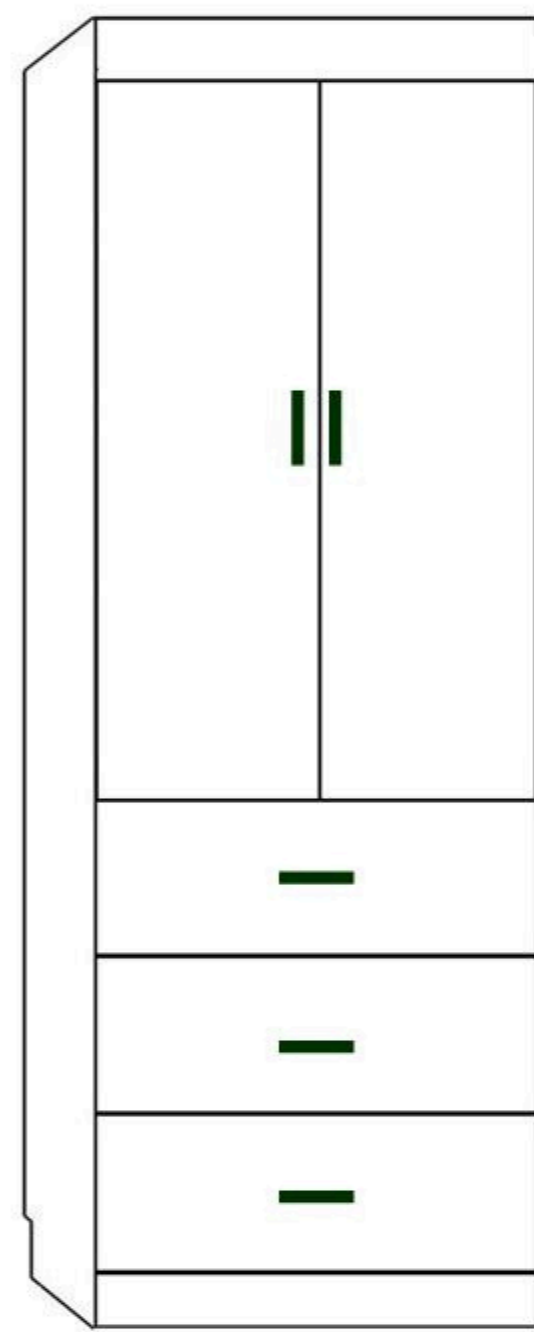

wardrobe 2 door

APWU—32" wide x 85" high

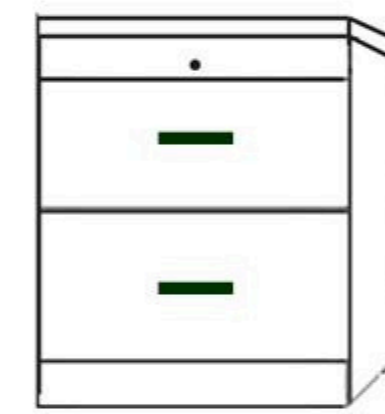

pull out tray  
2 drawer  
nightstand

ANST—24" wide x 16" deep  
x 28.5" high

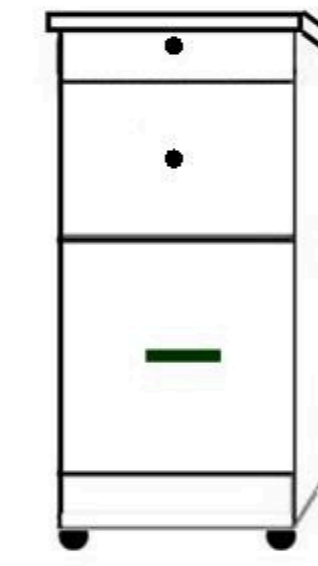

rolling file cart

AFC—16" wide x 22" deep x 28.5" high

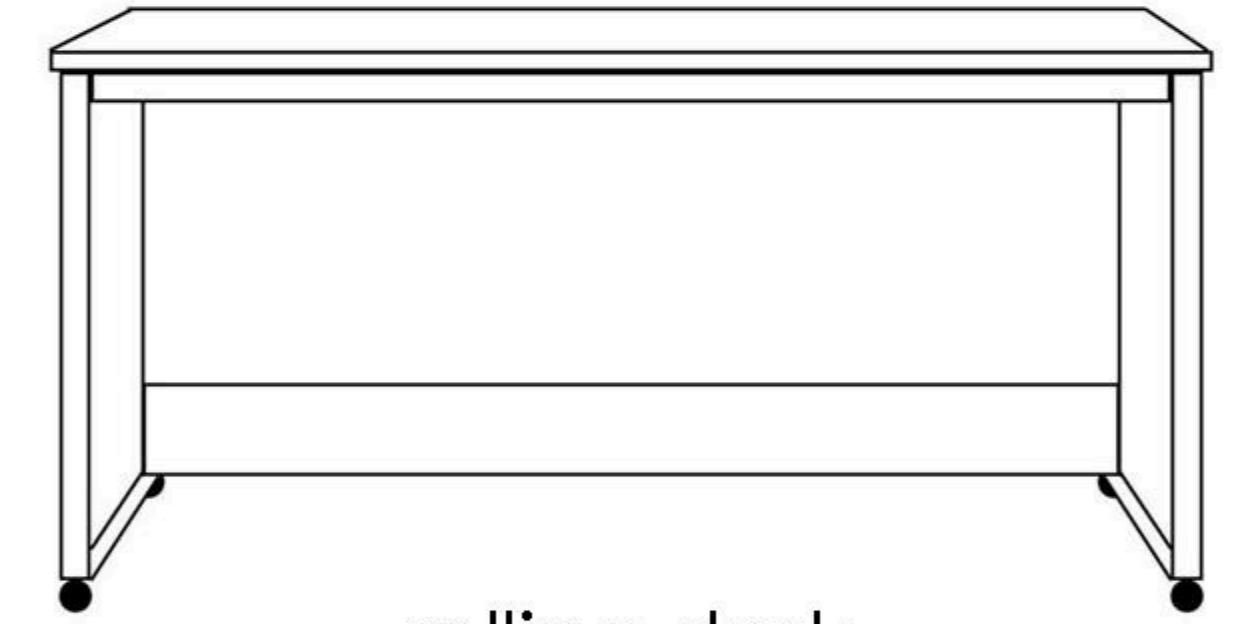

rolling desk

DC—63" wide x 22" deep x 31.5" high



straight desk set  
Specify left or right side facing

APCF—24" wide x 85" high  
or APCQ—24" wide x 90" high  
With AFD straight desktop and base



shaped desk set  
Specify left or right side facing

ADFL—32" wide x 85" high  
or ADQL—32" wide x 90" high  
With ALD Shaped desktop and base

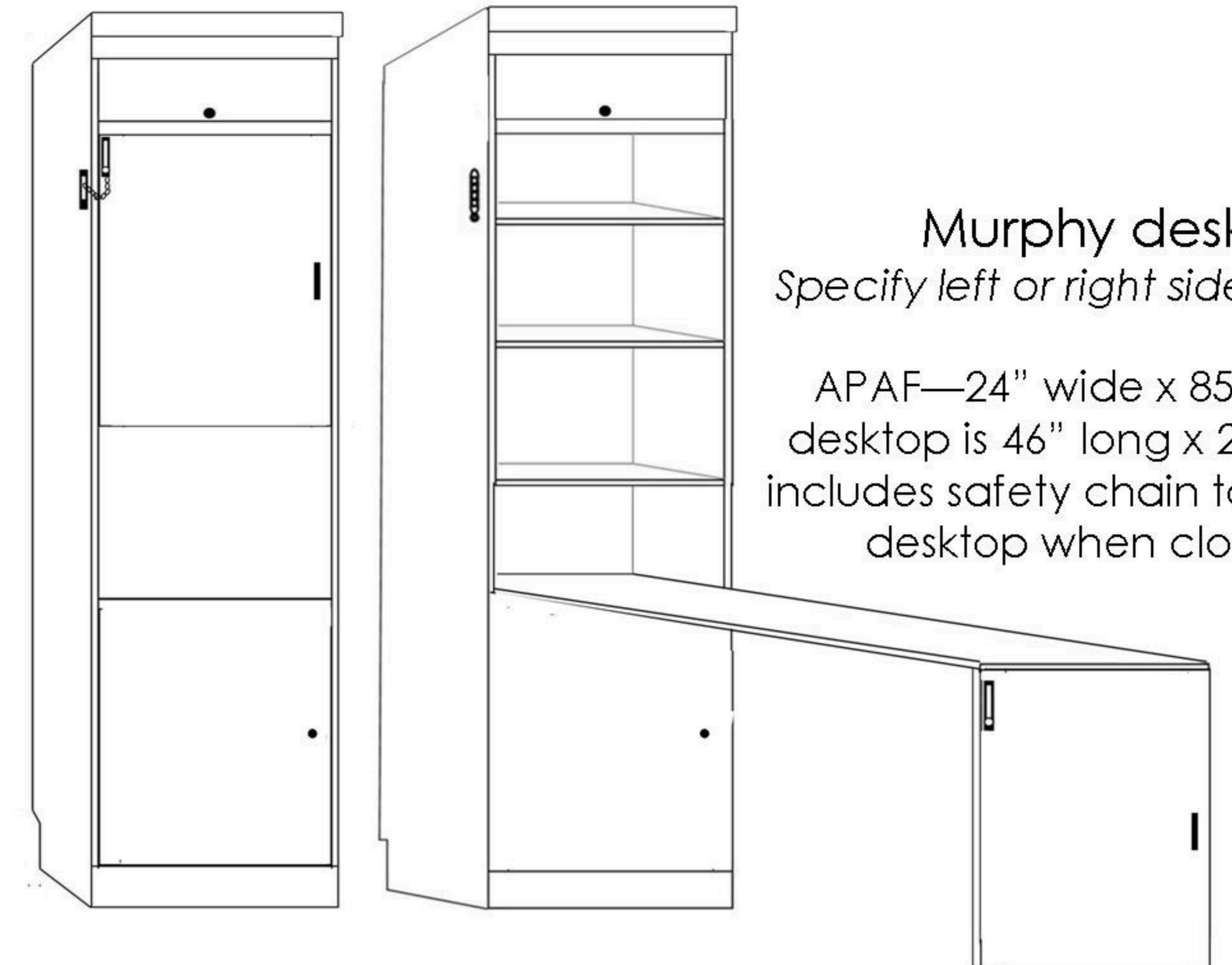

Murphy desk  
Specify left or right side facing

APAF—24" wide x 85" high  
desktop is 46" long x 29" high  
includes safety chain to secure  
desktop when closed